

Miller  
Since 1899

Miller  
NITRO<sup>®</sup> n2XP

NITRO



# Nitro N2XP Sprayers

Great value and high versatility



## 10-foot Turning Radius with Four-Wheel Steering

The 18-foot (5.5 m) turning radius with two-wheel steering can be reduced to 10-foot (3.05 m) with the optional four-wheel steering system. It can be used in three types of configurations:

- Two-wheel steering for normal use & road transportation.
- Four-wheel steering for field work, to reduce crop damage at headlands (front & rear wheels use the same track) or for tight headlands.
- Crab position that can be used in hilly conditions.



## High Levels of Performance

The Cummins 6.7 L QSB Tier III engine, featuring 215 HP (power bulge to 225 HP) can power through the toughest field conditions while reaching an impressive 36 mph on the road. An in-cab diagnostic display provides easy engine monitoring.

The Twin Sauer Danfoss Torq-Trac™ hydrostatic drive pumps, coupled to four Poclain MW14 wheel drive motors, make for an explosive delivery of power and torque. The optional SmartDrive® traction control manages the flow of hydraulic oil to each wheel drive motor, preventing individual wheels from spinning in difficult field conditions.

Three shift-on-the-go speed ranges provide increased torque at low speeds and allow for higher travel speeds.

Speed Ranges	1	2	3
mph	12	18	36*
Km/h	19.2	28.8	58*

\*Do not exceed tire manufacturers' maximum load rating & permitted speed. Speeds will vary based on tire size & field conditions.

## Integrated Brake System

As with the Nitro 4000 Series, the N2XP features four-wheel dynamic braking, along with traditional hydrostatic braking, ensuring positive stopping power. Four-wheel parking brakes are standard.

## Highly Efficient Cooling System

The N2XP uses a large "single pass" design cooling system with a large diameter hydraulically driven fan. This allows for more efficient and cooler air flow through all four cores, along with easier service.

Sections from left to right: air conditioner condenser, oil cooler, air-to-air after-cooler and radiator.

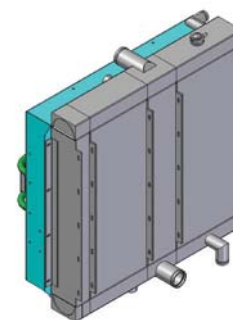

# The N2XP Shines in Row Crops

Better traction, less compaction equals higher productivity

**Miller**  
Since 1899



## Made for Specialty Crops

The Nitro N2XP's ability to use unique wheel spacing configurations makes it an ideal fit for most row crop applications. The ability to hydraulically change the wheel spacing from 74" to 120" (188 to 305 cm) allows the operator to perform in an almost limitless array of crop configurations.

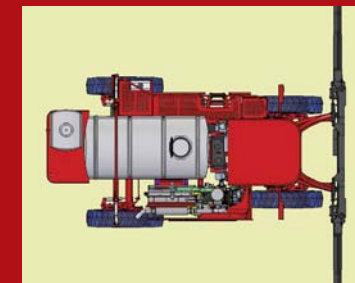

To further minimize compaction, the front and rear wheels can be spaced at different widths.

## Air Bag Suspension for Quality Ride

With long days being the norm during the spraying season, the N2XP has been equipped with an air bag suspension for maximum operator comfort.

- Four-wheel, independent air-ride suspension with fully enclosed and pressurized strut-style system that keeps slide mechanism clean
- Integrated leveling valve for each strut



- On-board engine driven air compressor
- Air-Ride cab with leveling system and Deluxe Air-Ride seat
- Narrow leg profile for minimum crop damage

## Balanced Weight for Increased Traction and Less Compaction

The N2XP's excellent weight distribution improves traction and results in less soil compaction.

Boom Open	Front Axle	Rear Axle
Tank Full	49%	51%

Nitro N2XP, 90' boom, 1000 Gal. Tank, Fuel & Rinse Tanks full: both 100 Gal.

## Operator Environment

The spacious 90 Series cab offers exceptional comfort, low sound levels and features a charcoal filtration system. The operator can adjust spraying controls easily while maintaining a clear view of the entire boom. Meanwhile, access to the cab, product tank and foam marker is easy with the large walk-way platform and a ladder that raises and lowers hydraulically with the parking brake. Additionally, the operator has complete in-cab control of the foam marker injection system by using the water from the rinse tank without the need to pre-mix.



# A Versatile Multi-Tasker

The Nitro N2XP does it all

Specifications	<b>NITRO N2XP</b>	
<b>Cab</b>	Air-ride cab with leveling valve, pressurized, with charcoal filter & secondary filter	
<b>Engine – Tier III (160 amp alternator)</b>	Cummins QSB 6.7 Liter	
<b>Horsepower</b>	215 – Power bulge to 225	
<b>Fuel Tank</b>	100 Gallons (379 L)	
<b>Cooling Package</b>	"Side-by-Side" single pass design, hydraulically driven fan	
<b>Air Compressor</b>	Direct engine driven, water cooled air compressor	
<b>Transmission</b>	Torq-Trac® hydrostatic drive system with Twin Sauer Danfoss heavy duty pumps	
<b>Aux Hydraulic Circuit – Closed Center</b>	31 GPM (117 L/min)	
<b>Speed Ranges</b>	3-speed	
<b>Parking Brake</b>	4-wheel	
<b>Service Brake</b>	Hydrostatic with multiple wet disc on 4 wheels	
<b>Steering</b>	Hydrostatic with two steering cylinders. No tie rods.	
<b>Standard 2-Wheel Steering</b>	18' (5.5 m)	
<b>Optional 4-Wheel Steering</b>	Optional, 10' (3.05 m)	
<b>4-Wheel Independent Suspension</b>	8" (20.3cm) travel/air strut	
<b>Product Tank Options (SS: Stainless Steel)</b>	1000 gal. (3785 L) poly or SS	
<b>Rinse System</b>	Manual or in-cab controls with 100 gal. (378 L)	
<b>Product Pump</b>	Hypro 9306C – 210 gpm @ 80 psi (795 L/min @ 5.5 bar) Pump Capacity Only	
<b>Foam Marker</b>	Injection system – 6 gal. (41 L) foam concentrate tank	
<b>Boom Options</b>	60' – 60/75' – 60/80' – 60/90' – 60/100' – 18/27m – 18/30m – 18/32m	
<b>Boom Lines w/ Feeder Lines</b>	1" (2.5cm) poly or stainless steel w. 1" (2.5cm) feeders	
<b>Boom Travel*</b>	From 17" (43 cm) to 94" (239 cm)	
<b>Tread Width Adjustment</b>	74" to 120" (188 to 305 cm) Hydraulic adjustment standard	
<b>Crop Clearance*</b>	50" (127 cm)	
<b>Wheel Base</b>	150" (381 cm)	
<b>Dimensions* (Shipping)</b>	H: 144" (366 cm) / W: 134" (340 cm) L: 236" (599 cm)	
	*Varies with tire and boom sizes.	Specifications subject to change without notice.



## Tanks & Liquid System

This mid-size sprayer, designed to meet the needs of both farm operators and custom applicators, is equipped with a 1000 gallon (3785 Liters) poly or SS product tank.

The N2XP uses a variable-speed Hypro® centrifugal pump equipped with a demand sensing system that directs the pump's speed to your target flow, reducing horsepower needs and increasing product pump life.

## Rear Fill Station

The entire product system is attached to the tank saddle for easy removal when changing to a dry system. The fill station has been positioned at the rear of the sprayer to group all controls together in order to minimize filling time. Remote throttle and pump switches are positioned next to the 2" Quick-Fill. The optional fill hopper is made of stainless steel for easy cleaning and features an integrated jug-and-hopper rinse system.



## Minimum Crop Damage

To further protect crops the N2XP can be equipped with wheel shields. The smooth design gently divides thick row crops. The flexible 12" (30.5 cm) rubber belted skirt resists the damage that can be caused by rocks or muddy fields.

**Miller**  
Since 1899

Miller-St. Nazianz, Inc.  
511 E. Main St., St. Nazianz, WI 54232-0127  
800-247-5557 / [www.millerstn.com](http://www.millerstn.com)